



## Land At The White Hart, Ruislip Road Northolt, UB5 5AX

### Rarely Available Prime West London Open Storage & Logistics Compound / Hub

**24,434 sq ft**  
(2,269.99 sq m)

- Prime Logistics Location
- Heathrow Airport (7 Miles)
- Central London (13 Miles)
- Flexible Lease Terms
- Crushed Type 1 Surface
- Water & Electric
- Secure Gated Compound

# Land At The White Hart, Ruislip Road, Northolt, UB5 5AX

## Summary

<b>Available Size</b>	24,434 sq ft
<b>Rent</b>	Rent on application
<b>Business Rates</b>	N/A
<b>VAT</b>	Applicable
<b>Legal Fees</b>	Each party to bear their own costs
<b>EPC Rating</b>	Upon enquiry

## Description

This is a rare opportunity to secure a premium, self-contained open storage compound in one of London's most strategically important logistics zones. The compound is fully secured with perimeter hoarding and metal gating.

The site comprises net usable area approx. 24,434 sq ft (0.56 acres) of level, fully hardstanding ground protected by newly installed perimeter fencing and gated access. It is an ideal platform for logistics & distribution, plant & equipment hire, secure vehicle storage, container & pallet storage, aviation support services or commercial vehicle operators.

Note: There is a Grade II listed building on the site which is not included in the lease and will need to remain boarded up.

## Location

Located off Ruislip Road (A4180) immediately adjacent to the A40 Western Avenue Corridor, this site sits at the heart of West London's logistics triangle.

Heathrow Airport is 7 miles South via the A312 and central London is 13 miles East via the A40. The site is also only 9 miles from the M25 (junction 15) and 1.3 miles away from Northolt underground station and is well served by numerous bus routes.

## Viewings

Strictly by appointment of sole agents.

## Terms

### OPTION 1: SHORT-TERM FLEXIBILITY

- 3-year Lease Term
- Mutual rolling break on 6 months' notice

### OPTION 2: LONG-TERM SECURITY

- 9-year Lease Term
- 3-yearly rent reviews

## Drone Video

<https://vimeo.com/1151942809?share=copy&fl=sv&fe=ci>

## Video

- Drone video - <https://vimeo.com/1151942809?share=copy&fl=sv&fe=ci>

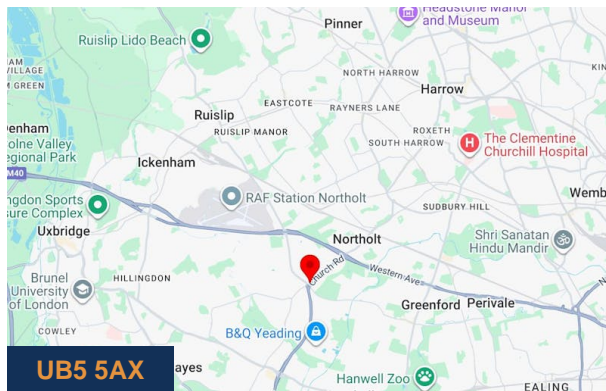

## Viewing & Further Information



**George Moriarty**



020 8429 9003 | 07522 700 507

[george@davidcharles.co.uk](mailto:george@davidcharles.co.uk)

The above information contained within this email is sent subject to contract. These particulars are for general information only and do not constitute any part of an offer or contract. All statements contained therein are made without responsibility on the part of the vendors or lessors and are not to be relied upon as statement or representation of fact. Intending purchasers or lessees must satisfy themselves, by inspection, or otherwise, as to the correctness of each of the statements of dimensions contained in these particulars. Generated on 19/06/2026

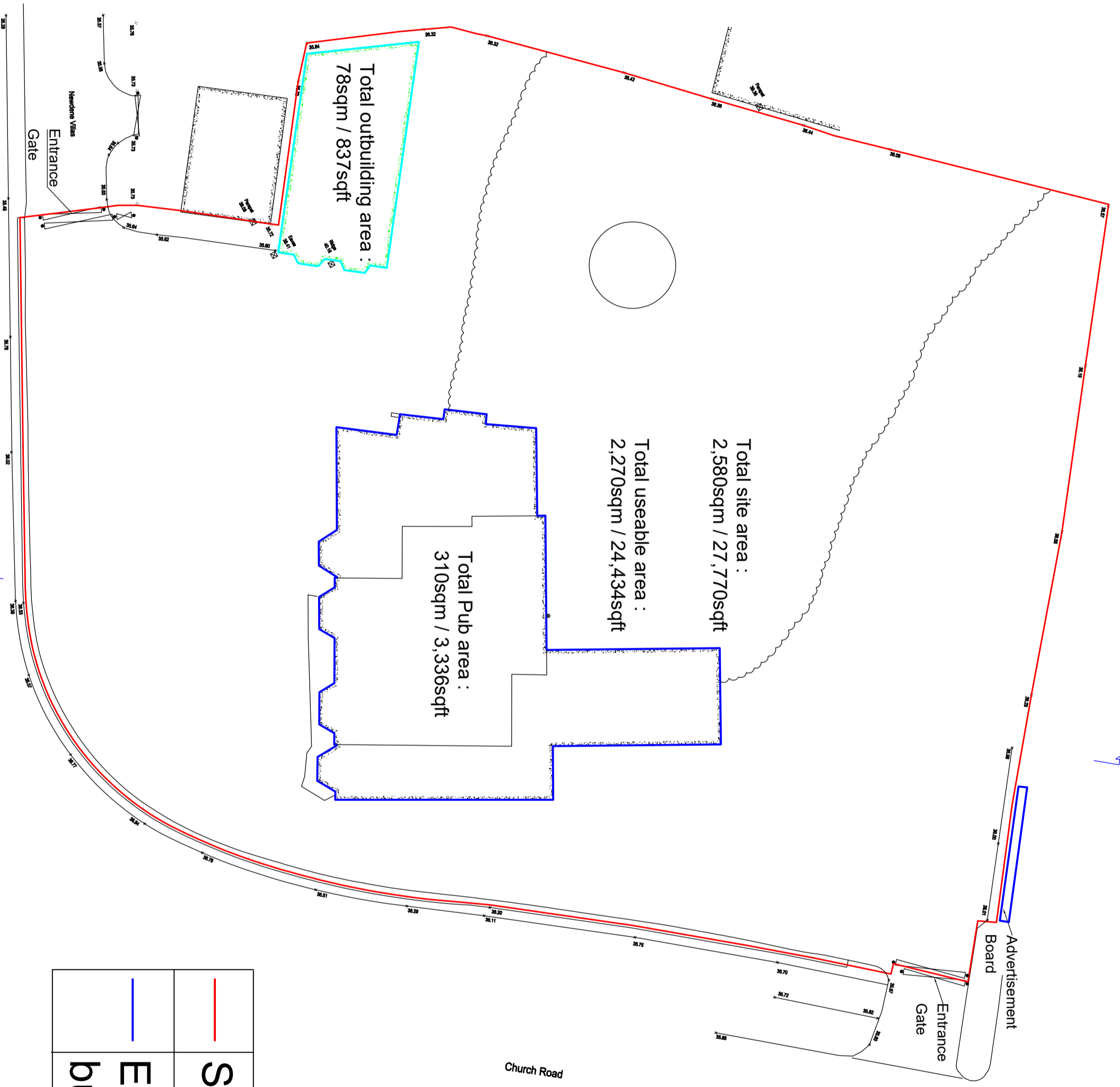
# Existing Plan



	<b>Site boundary</b>
	<b>Existing building</b>